

Remoter Controller

1.INTRODUCTION

is mini wireless remoter controller with 6 keys; it is one of important accession of our company, has the function of controlling the wireless products. With special out look, it can be decoration and convenient for taking. It is easy for using, has high sensibility in 30 meters. After coding with wireless products, it controls wireless products, except the traditional keys for ALARM and DISALARM, new keys added for wireless electronic control, and emergency bottom key for you to send out emergency immediately. For better protection of your security, it is good choice for your smart home system.

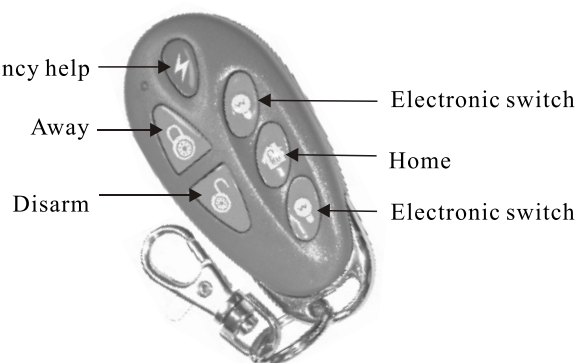

2.SPECIFICATION

Using range: 100m

Frequency: 433MHz

Code: 28 bits ID, 8 bits function code, 36 bits date code

Voltage: 5.8V-7V. With two CR2032 Lithium batteries, working life is about one year

Information emission: LED lighting

Temperature: -10℃ ~ 50℃

Size: 73*35*14mm

Weight: 22g

Colour: grey

3.MAIN FUNCTION

A. 6 independent function keys

B. For fast arm/disarm, easy and convenient, emergency call, safe and covert.

C. Wireless electronic control

D. Exquisite design, with pictures for key functions easy explain

E. Scientific address code with millions of combination, which enable all the remoter controller to be exclusive one, without permitting, it is impossible to copy our wireless products

F. Low consumption for transmitting, indication for signal out put visible

G. Compatible with all our 433MHz wireless products

4. USING

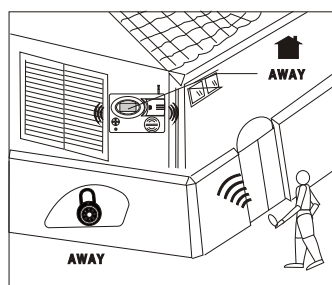

1. For away arm, press the key
AWAY for 2 seconds

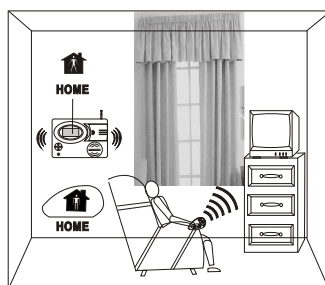

2. For at home arm, press the key
HOME for 2 seconds

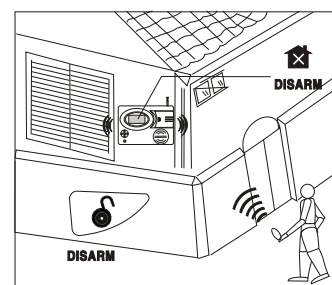

3. For disarm, press the key DISARM
for 2 seconds

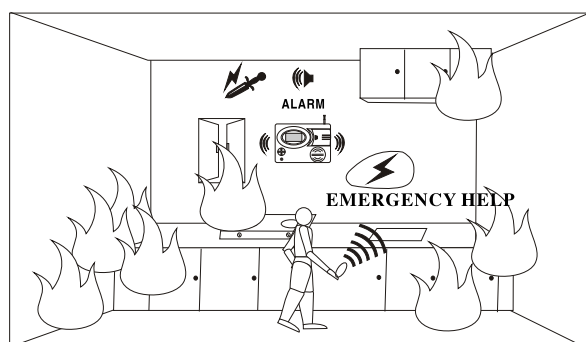

4.The emergency help is safe and covert,
press the key HELP for 3 to 4 seconds to
realize this function

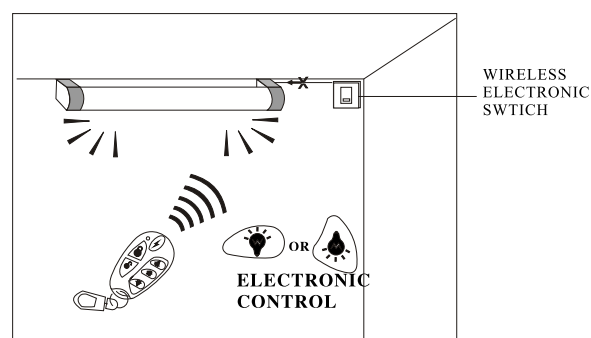

5. For electronic control, 48 electronics
can be controlled.

5. TEST AND MAINTENANCE

5.1 Coding

1. The control keys for **Remoter** can be divided into 2 groups, alarm control keys and electronics control keys, in the process of code with different products, we should use the corresponding keys for sending signal:

For example: when we need to code the remoter controller with a wireless electronic switch, we should press any electric control key for signal emission; and when we need to code the remoter controller with other wireless products, we should press any alarm control key for signal emission. .

2. The electronic control key can be divided into 3 independent groups, every group can control one wireless electronic switch, as it showing in the picture left:

Keys of every group can be touched at the same time as the other keys for alarm control, and keys of every group can control one wireless electronic switch, up to 48 switches.

3. Keys for electronic switch control: it can also work as wireless doorbell code with control panel, after coding, whenever the control key touched, the control panel will sounds with music.

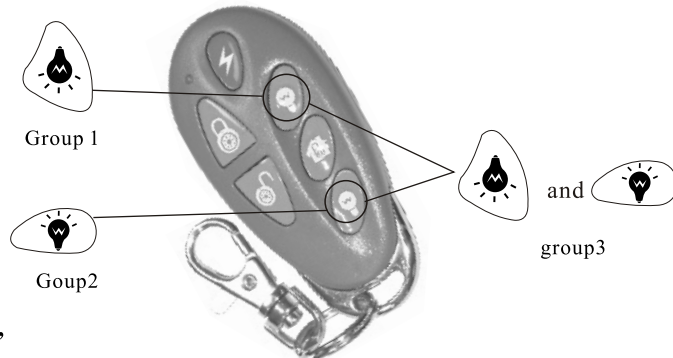

5.2 Test

When finished in the factory, Remoter has build-in batteries. Before testing, we will need to code wireless products with PB-403R, for the coding details, please view the CODE SETTING of the manual of wireless products. The testing process as following;

1. Keep the distance of Remoter from the wireless products above 3 meters; press the key with lock picture one the remoter controller for 2 seconds, the lamp for checking receiver's state should light twice.
2. Confirm the wireless products have the same response, such as hear the hint voice SYSTEM ALARM.
3. Operate in the corner of covered zone of wireless products, such as the place blocked by wall and large object, to see if the system has the same hint voice.

5.3 Change batteries

The batteries should be changed every 6 month, or the signal may fade in the process of transmitting. The batteries should be 6V Lithium batteries, please follow the below steps to change the batteries.

1. Use a small screw driver to open the small screw on the back of the remoter controller. Keep the screw carefully.
2. Fetch the back cover and pull out the old batteries.
3. Input the new batteries, pay attention to the anode and cathode.
4. Fix the back cover with the screw.
5. Test the installed batteries: press any key, the LED lamp on the remoter controller lighting, the control panel will response correspondingly.

6. SYSTEM LIMITED

Our wireless products are reliable, while in certain situation, our system will be limited, the situation can be some one as below:

1. When the control panel is not stable, or the remoter controller is not in the covered range, it may lead to signal sending not success.
2. Undervoltage of the remote controller, etc.

For any requirement for help, please contact with our company.

FCC NOTE: THE MANUFACTURER IS NOT RESPONSIBLE FOR ANY RADIO OR TV INTERFERENCE CAUSED BY UNAUTHORIZED MODIFICATIONS TO THIS EQUIPMENT. SUCH MODIFICATIONS COULD VOID THE USER'S AUTHORITY TO OPERATE THE EQUIPMENT.

This device complies with Part 15 of the FCC Rules. Operation is subject to the following two conditions:

1. This device may not cause harmful interference, and
2. This device must accept any interference received, including interference that may cause undesired operation.